



VIEW



COMFORT



DURABLE

COLO 8550

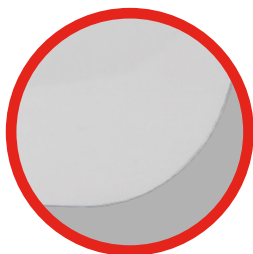

CHARACTERISTICS

- The visor is made of polycarbonate
- Anti-scratch and anti-fog coating
- This stylish, spherical visor provides good protection against small particles, both from the front and the sides
- The visor was designed to protect the wearer's face against various risks against which glasses or safety goggles alone do not provide sufficient protection
- The visor can be used with the OXXA Casita 8500 or the OXXA Colima 8510 combined with an OXXA safety helmet
- Size: 400 mm (L) x 202 mm (H)
- Thickness: 2.2 mm
- Weight: 224 grams

Article number: 7.78.550.00

SUITABLE FOR ACTIVITIES IN E.G.

- Construction
- Shipbuilding
- Laboratories
- Metal industry
- Petrochemistry
- Transport & logistics

COLOUR

Transparent

SIZES

One size

PACKAGING

- 1 item in PE bag
- 50 items in outer box



EN 166:2001
EN 170:2002

PRODUCT INFORMATION

SIZE	ARTICLE NO.	EAN CODE 1 UNIT (PE BAG)	EAN CODE 50 UNITS (OUTER BOX)
One size	7.78.550.00	8718249044274	8718249044298

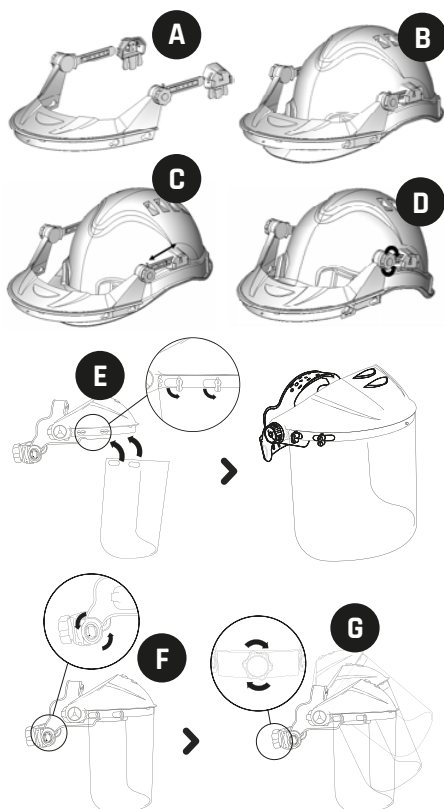

WEARING INSTRUCTIONS

Installation and adjustment of the visor holder for use with a safety helmet and visor

The visor holder for use with a safety helmet must always be used alongside the visor in order to provide adequate protection.

- Place the visor holder into the helmet adapter (figure **A**)
- Slide the combined visor holder & helmet adapter into the slots on both sides of the helmet (figure **B**)
- Adjust the length of the visor holder by moving the arms forward or backward until you achieve a good fit (figure **C**)
- Use the knobs to tighten or loosen the visor holder and to adjust the position of the visor holder (figure **D**)

The visor must be placed into the visor holder. Place the visor with the hole in its centre over the pin in the middle of the visor holder. Next, slide the visor underneath the two supports on both sides of the pin in the centre. There are two locking pins on both sides of the visor holder. Slide the visor over these two locking pins on one side and turn the pins to lock the visor in place. Do the same on the other side of the visor. The product is now ready for use. To remove a component, simply complete the installation steps in reverse order.

Installation and adjustment of the visor holder and visor

The visor holder must always be used alongside the visor in order to provide adequate protection.

- The visor must be placed into the visor holder. Place the visor with the hole in its centre over the pin in the middle of the visor holder. Next, slide the visor underneath the two supports on both sides of the pin in the centre. There are two locking pins on both sides of the visor holder. Slide the visor over these two locking pins on one side and turn the pins to lock the visor in place. Do the same on the other side of the visor. The product is now ready for use. (figure **E**)
- Using the two wheels on the left and right side of the holder, you can loosen or tighten the fit (figure **F**).
- The interior with knob can be adjusted by turning the knob into the desired position. You can use the knob to loosen or tighten the holder (figure **G**)

LENS MARKING

2-1,2 OXXA 1 BT 3 8 9 CE EN 166

2-1,2 = Ultraviolet filters in accordance with EN 170:2002

1 = Optical class 1 (Suitable for continuous activities)

B = Medium impact

T = Protection against impacts at extreme temperatures (+55°C / -5°C)

3 = Protection against liquid droplets and splashing

8 = Protection against electric arc discharges caused by short circuits

9 = Protection against molten metals and hot solid materials

STORAGE, MAINTENANCE AND CLEANING

Keep the product in its original packaging. Store the product at room temperature in a dry, clean and well-ventilated area. Keep the product out of direct sunlight and away from chemical and abrasive substances. To clean the product, always rinse with water at room temperature (20°C ± 5°C) and use a mild cleaning agent. If necessary, you can add a small amount of disinfectant to the water. Avoid using hot water or solvents. The visor must be cleaned with mild soap and water. Always dry the product with a soft cloth. Never use an abrasive cloth or dry the product on or near a heat source. Cleaning the product without water or with a rough cloth will result in scratches on the visor.

TESTING INSTITUTE

This visor has been certified by: BSI Group The Netherlands B.V. (Notify Body No. 2797), John M. Keynesplein 9, 1066 EP Amsterdam, the Netherlands.

DECLARATION OF CONFORMITY

For a copy of the declaration of conformity, we would like to refer you to the following web link:

www.oxxa-safety.com/doc

RELATED PRODUCTS



CASITA 8500

Art. no. 7.78.550.00



COLIMA 8510

Art. no. 7.78.510.00

YOUR SUPPLIER: